

Millimetres
0 10 100

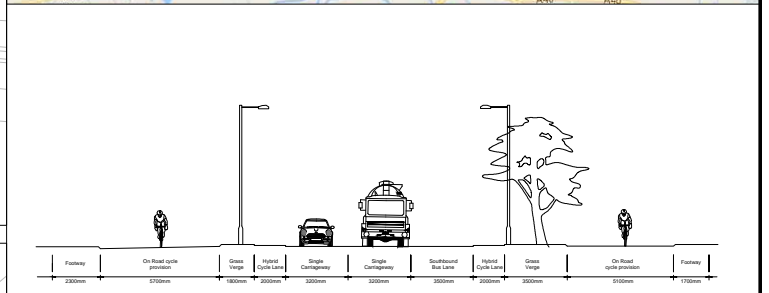
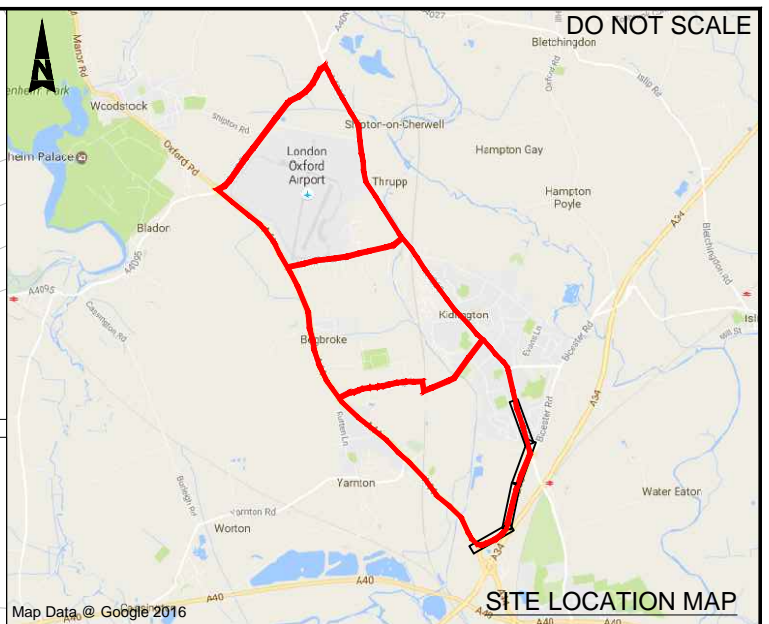
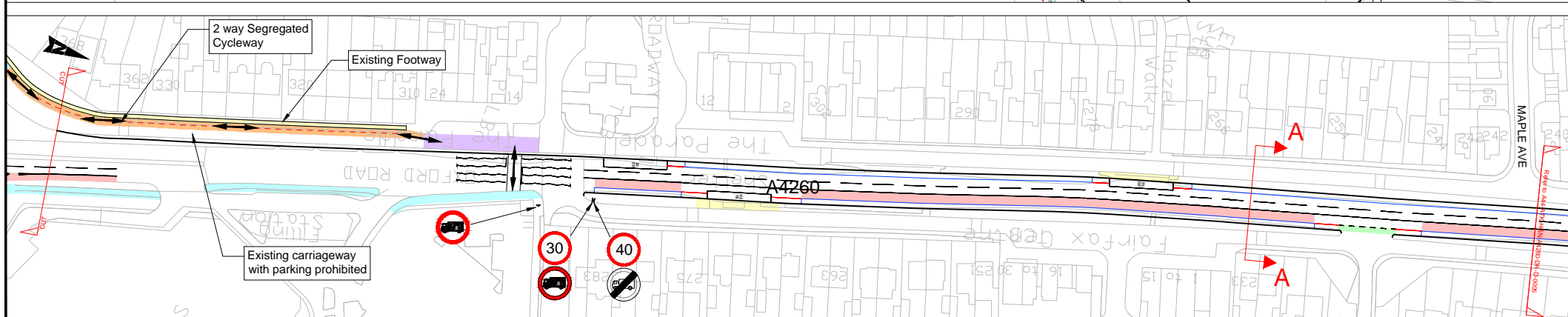
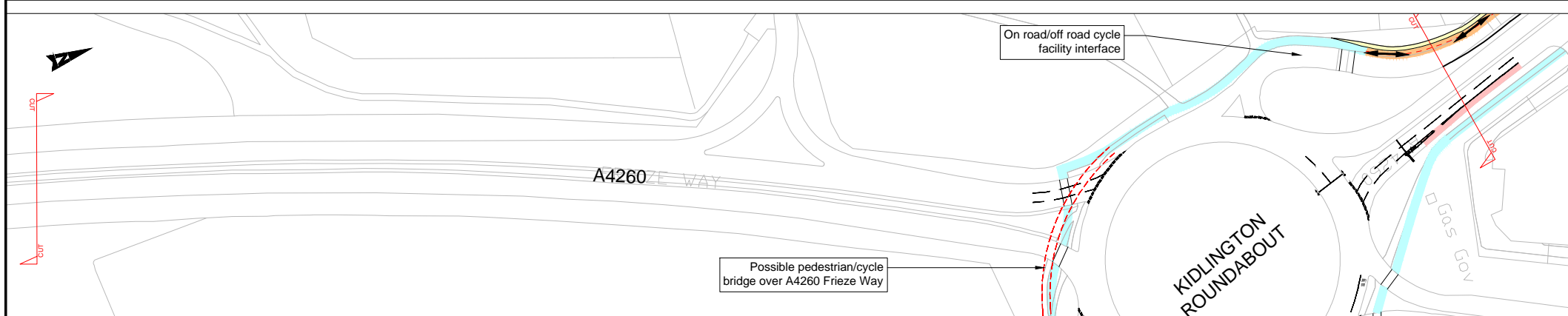
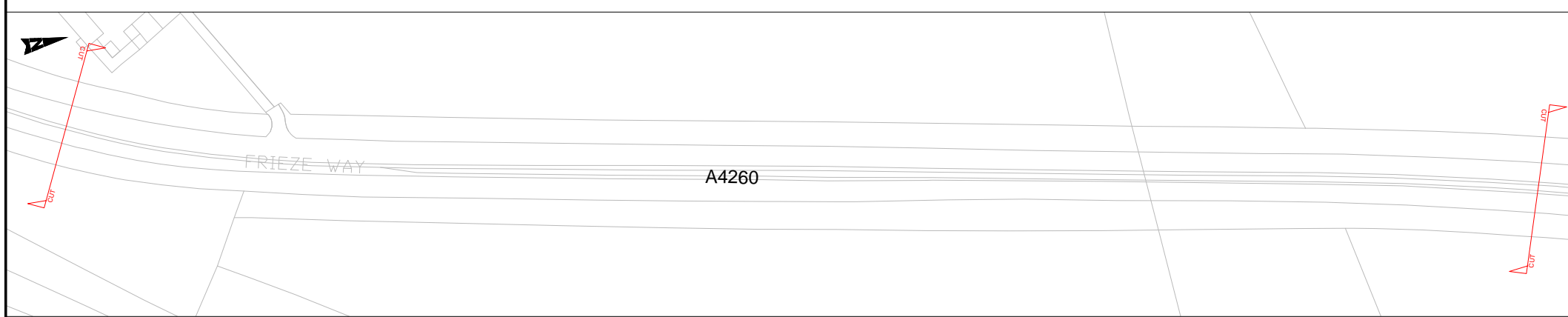
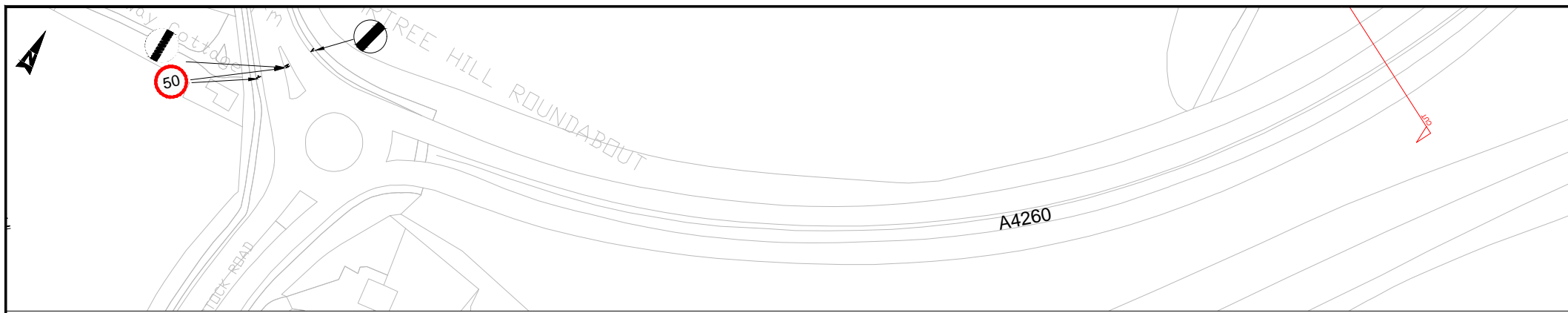

Notes

- All dimensions shown in millimeters based on OS mapping only.
- Proposals subject to confirmation of actual available widths from Topographical Survey and detail design.

Key:

Full Height Kerbline	Footway
Hybrid/Light Segregation	Shared Use Path (Segregated)
Mandatory Cycle Lane	Cycle Lane Hatching (Only Shown at Potential Conflict Points)
Advisory Cycle Lane	On road cycle provision incorporating possible speed control measures
On-Street Parking	2-way Segregated cycleway
Bus Lane	Preferred route for cyclists to take

SAFETY, HEALTH AND ENVIRONMENTAL INFORMATION			
In addition to the hazards/risks normally associated with the types of work detailed on this drawing, note the following:			
CONSTRUCTION			
NONE			
MAINTENANCE/CLEANING			
NONE			
DECOMMISSIONING/DEMOLITION			
NONE			
It is assumed that all works will be carried out by a competent contractor working, where appropriate, to an approved method statement			

FOR INFORMATION

The Hub
500 Park Avenue
Almondsbury
Bristol
BS32 4RZ
Tel: +44 (0)1454 662000
Fax: +44 (0)1372 663333
www.atkinsglobal.com

Copyright © Atkins Limited (2014)

Client: OXFORDSHIRE COUNTY COUNCIL

Project Title		A44-A4260 OXFORD CORRIDOR STUDY			
Drawing Title		A4260 PROPOSED LAYOUT SHEET 1 OF 3 (OPTION 4)			
Scale	Designed	Drawn	Checked	Authorised	
1:1000	PDE	HM			
Original Size	Date	Date	Date	Date	
A1	30/01/17	30/01/17	00/00/00	00/00/00	
Drawing Number	Originator	Volume	Project Ref. No.		
A44	ATK	HGN	5154309		
A4260	- DR - D	- 0004d	Revision		
Location	Type	Role	Number	P1.2	

Rev.	Date	Description	By	Chkd	App'd
P1.2	04.04.17	CLIENT COMMENTS			HM
P1.1	30.01.17	DRAWING CREATED			HM

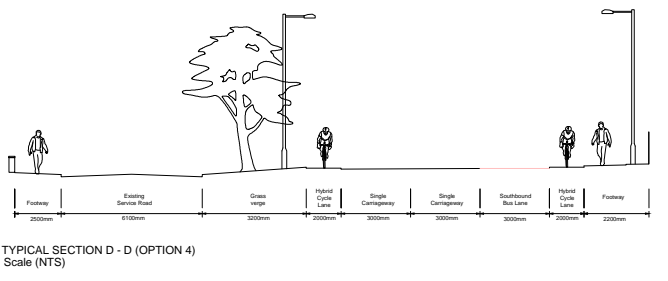
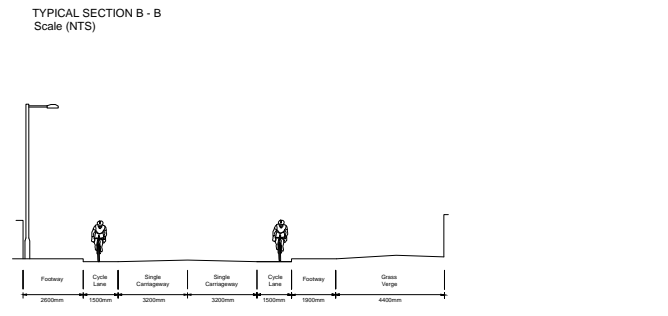
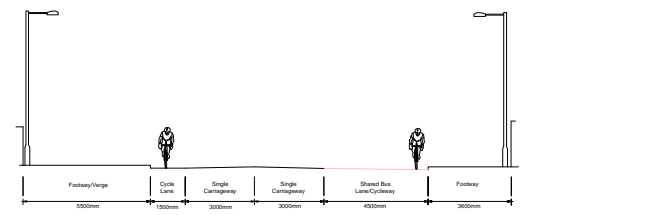
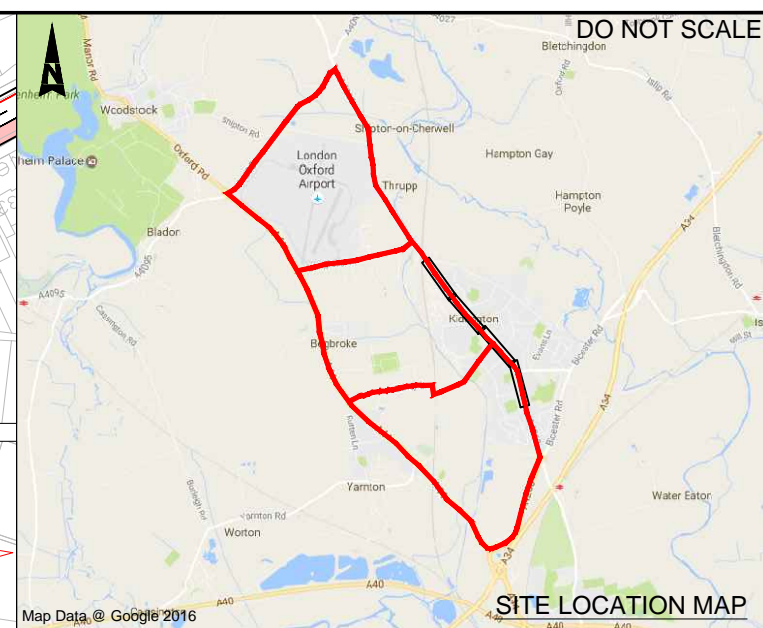
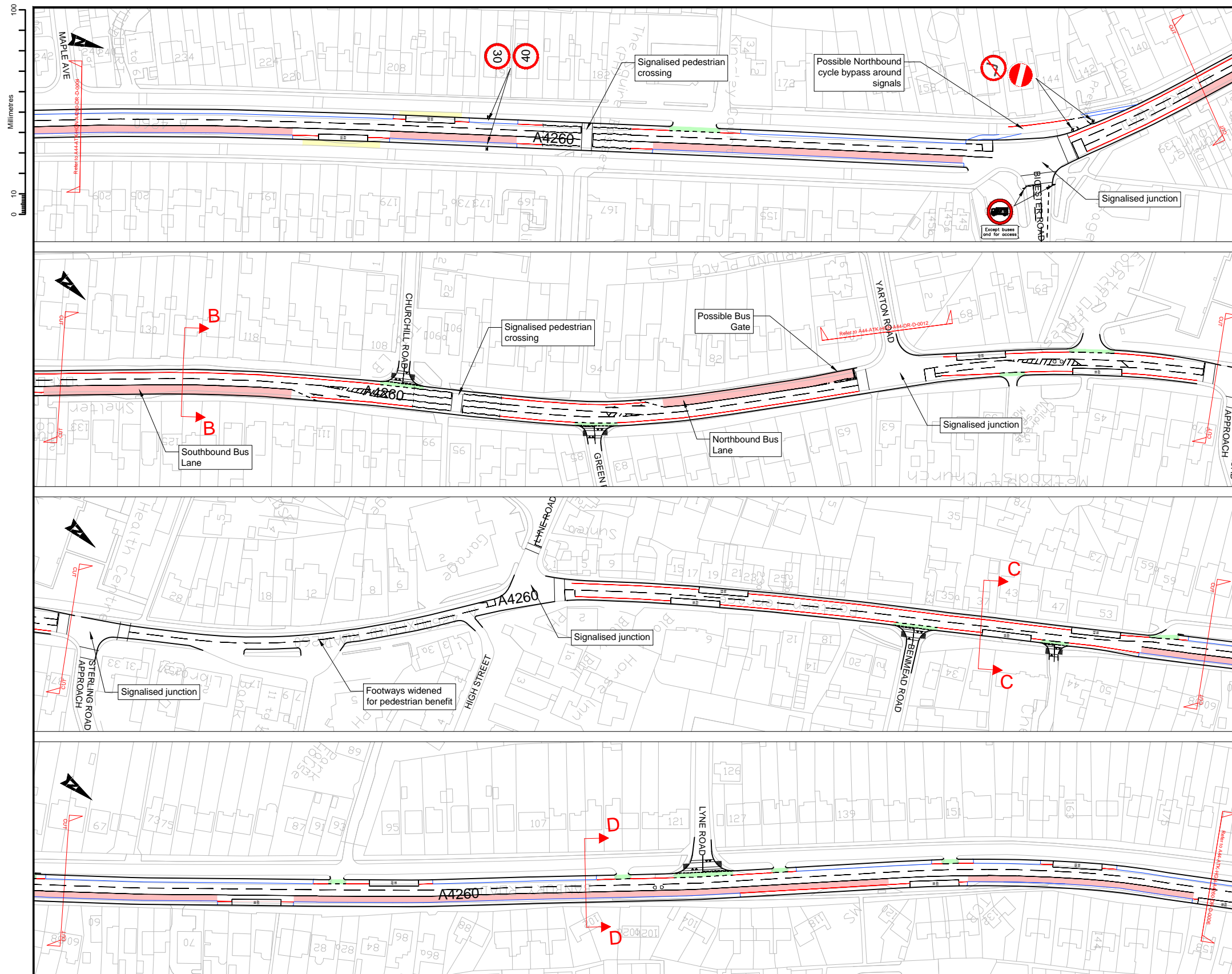

- Notes**
- All dimensions shown in millimeters based on OS mapping only.
 - Proposals subject to confirmation of actual available widths from Topographical Survey and detail design.
- Key:**
- Full Height Kerbline
 - Hybrid/Light Segregation
 - Mandatory Cycle Lane
 - Advisory Cycle Lane
 - On-Street Parking
 - Bus Lane
 - Footway
 - Shared Use Path (Segregated)
 - Cycle Lane Hatching (Only Shown at Potential Conflict Points)
 - On road cycle provision incorporating possible speed control measures

SAFETY, HEALTH AND ENVIRONMENTAL INFORMATION			
In addition to the hazards/risks normally associated with the types of work detailed on this drawing, note the following:			
CONSTRUCTION			
NONE			
MAINTENANCE/CLEANING			
NONE			
DECOMMISSIONING/DEMOLITION			
NONE			
P1.2	04.04.17	CLIENT COMMENTS	HM
P1.1	30.01.17	DRAWING CREATED	HM
Rev.	Date	Description	By Chkd App'd
It is assumed that all works will be carried out by a competent contractor working, where appropriate, to an approved method statement			

<p>FOR INFORMATION</p> <p>The Hub 500 Park Avenue Aztec West Almondsbury Bristol BS32 4RZ Tel: +44 (0)1454 662000 Fax: +44 (0)1372 663333 www.atkinsglobal.com</p> <p>Copyright © Atkins Limited (2014)</p>	<p>Suitability</p> <p>SO</p>	Project Title		A44-A4260 OXFORD CORRIDOR STUDY						
		Drawing Title		A4260 PROPOSED LAYOUT SHEET 2 OF 3 (OPTION 4)						
<p>OXFORDSHIRE COUNTY COUNCIL</p>	Scale	1:1000	Designed	PDE	Drawn	HM	Checked		Authorised	
	Original Size	A1	Date	30/01/17	Date	30/01/17	Date	00/00/00	Date	00/00/00
	Drawing Number	A44	Originator	ATK	Volume	HGN	Project Ref. No.	5154309	Revision	
Location	A4260	Type	- DR - D	Role	- 0005d	Number				P1.2

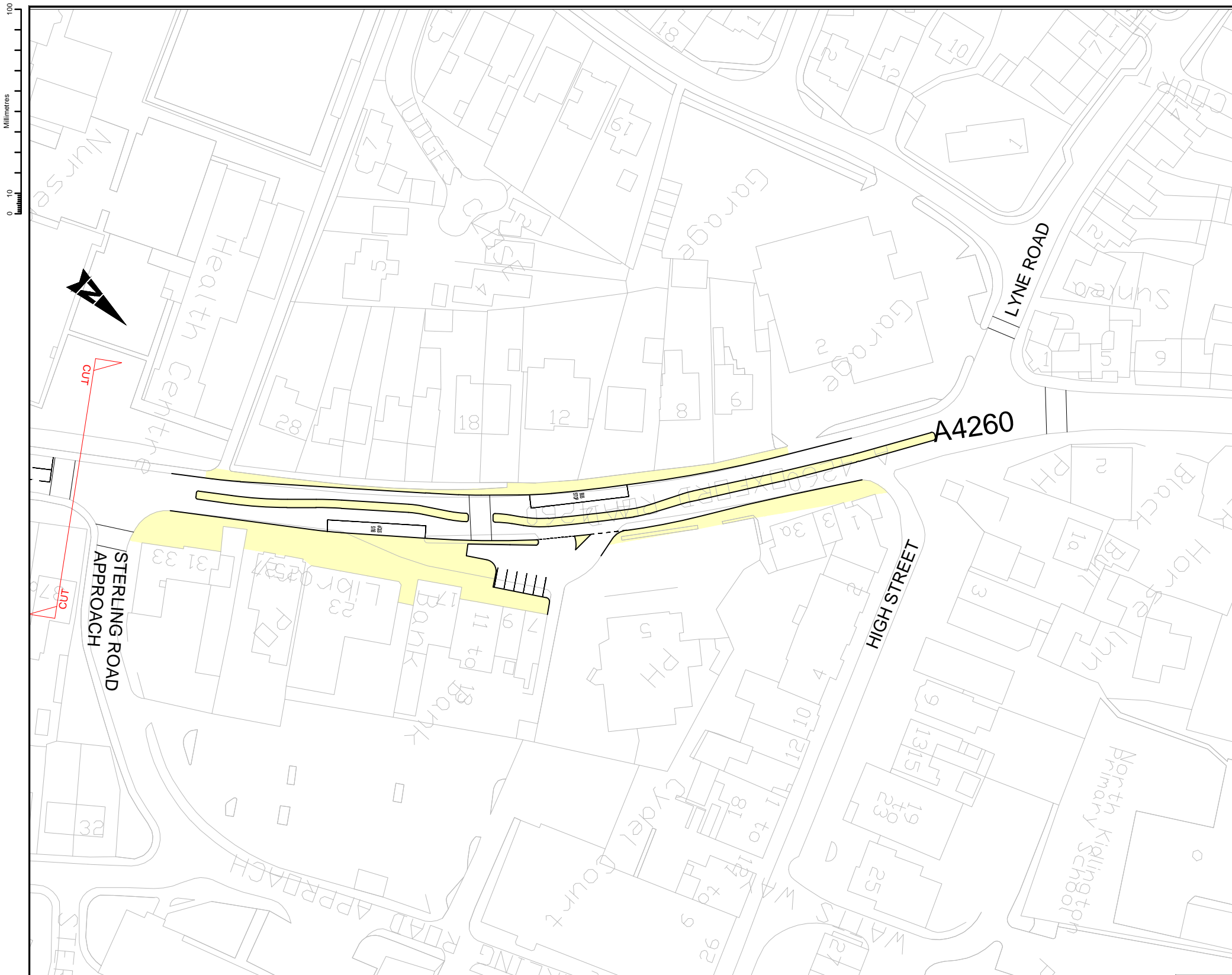

Notes

- All dimensions shown in millimeters based on OS mapping only.
- Proposals subject to confirmation of actual available widths from Topographical Survey and detail design.

Key:

- Full Height Kerbline
- Hybrid/Light Segregation
- Mandatory Cycle Lane
- Advisory Cycle Lane
- On-Street Parking
- Bus Lane
- Footway
- Shared Use Path (Segregated)
- Cycle Lane Hatching (Only Shown at Potential Conflict Points)
- On road cycle provision incorporating possible speed control measures

SAFETY, HEALTH AND ENVIRONMENTAL INFORMATION			
In addition to the hazards/risks normally associated with the types of work detailed on this drawing, note the following:			
CONSTRUCTION			
NONE			
MAINTENANCE/CLEANING			
NONE			
DECOMMISSIONING/DEMOLITION			
NONE			
P1.2	04.04.17	CLIENT COMMENTS	HM
P1.1	30.01.17	DRAWING CREATED	HM
Rev.	Date	Description	By Chkd Appd

Drawing Status		Suitability	Project Title	
FOR INFORMATION		SO	A44-A4260 OXFORD CORRIDOR STUDY	
ATKINS		The Hub 500 Park Avenue Aztec West Almondsbury Bristol BS32 4RZ Tel: +44 (0)1454 662000 Fax: +44 (0)1372 663333 www.atkinsglobal.com		
Copyright © Atkins Limited (2014)		Drawing Title A4260 PROPOSED LAYOUT SHEET 2 OF 3 (OPTION 5)		
Scale	Designed	Drawn	Checked	Authorised
1:500	PDE	HM		
Original Size	Date	Date	Date	Date
A1	30/01/17	30/01/17	00/00/00	00/00/00
Drawing Number	Originator	Volume	Project Ref. No.	
A44	ATK	HGN	5154309	
A4260	- DR - D -	0005e	Revision	
Location	Type	Role	Number	P1.2

OXFORDSHIRE COUNTY COUNCIL

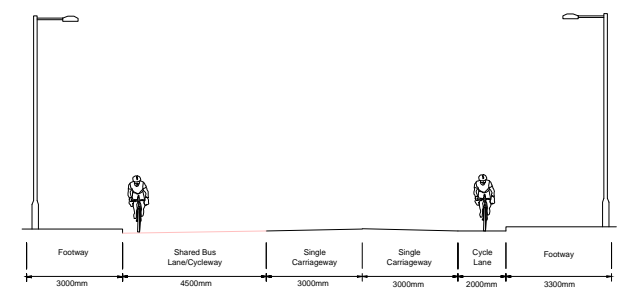
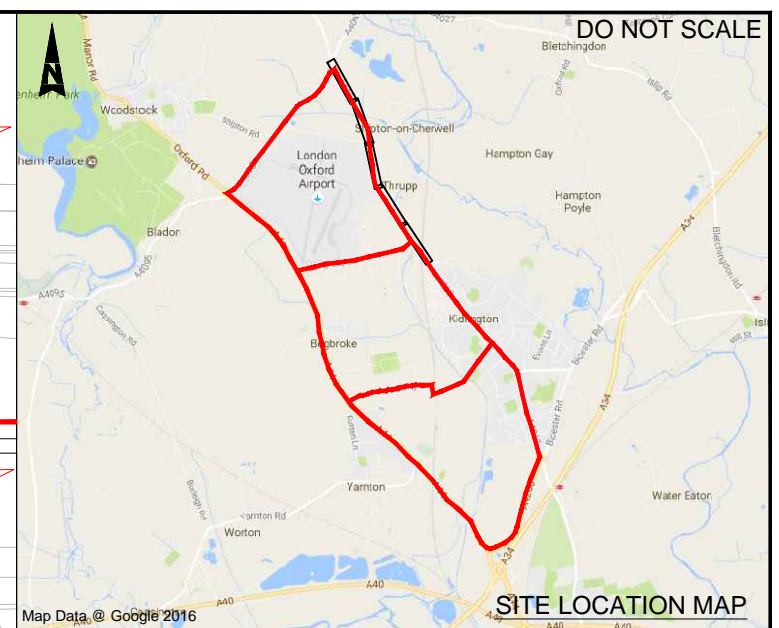
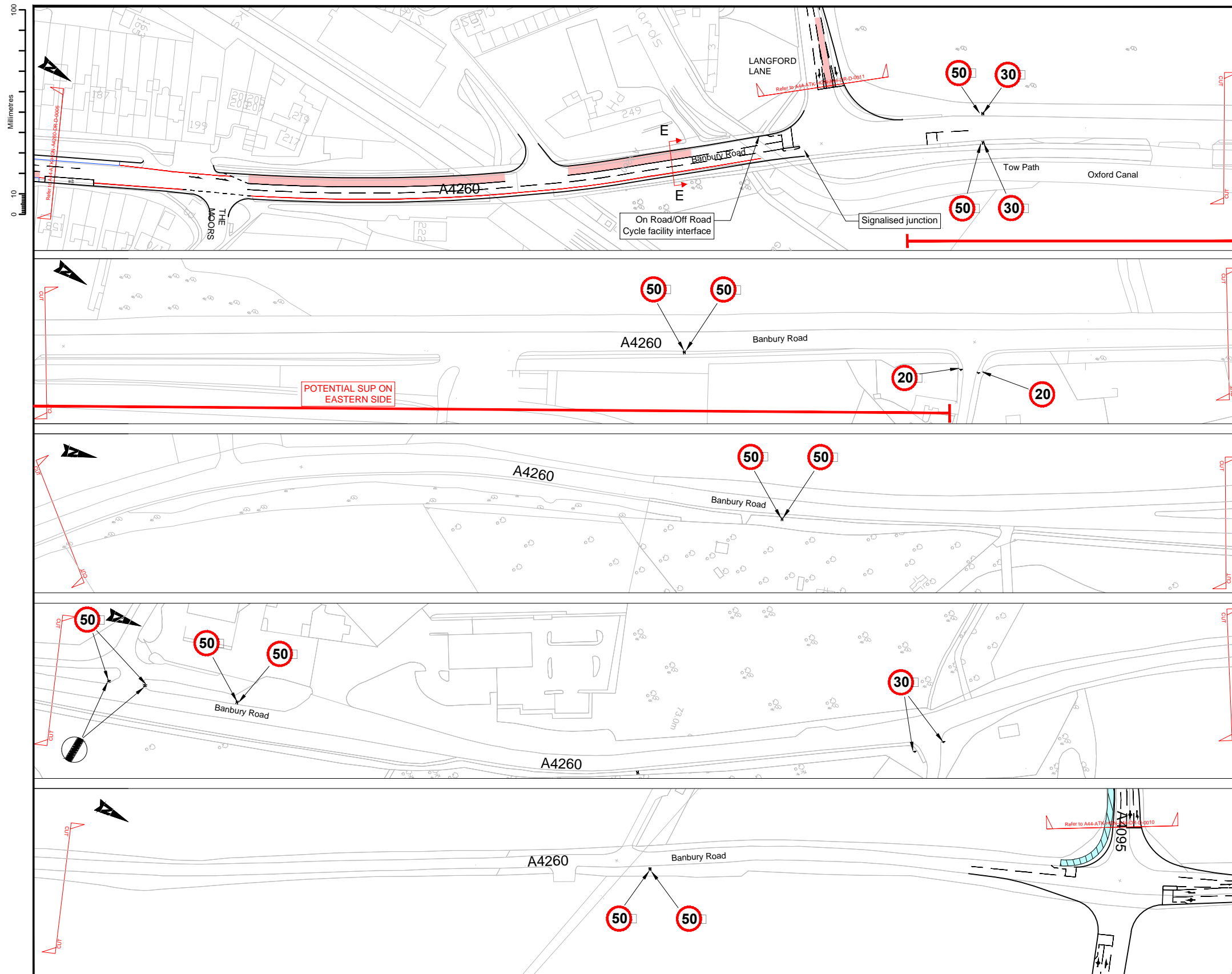

TYPICAL SECTION E - E
Scale (NTS)

Notes

- All dimensions shown in millimeters based on OS mapping only.
- Proposals subject to confirmation of actual available widths from Topographical Survey and detail design.

Key:

Full Height Kerbline	Footway
Hybrid/Light Segregation	Shared Use Path (Segregated)
Mandatory Cycle Lane	Cycle Lane Hatching (Only Shown at Potential Conflict Points)
Advisory Cycle Lane	On road cycle provision incorporating possible speed control measures
On-Street Parking	Potential Shared Use Path, Subject to future demand
Bus Lane	

SAFETY, HEALTH AND ENVIRONMENTAL INFORMATION					
In addition to the hazards/risks normally associated with the types of work detailed on this drawing, note the following:					
CONSTRUCTION					
NONE					
MAINTENANCE/CLEANING					
NONE					
DECOMMISSIONING/DEMOLITION					
NONE					
It is assumed that all works will be carried out by a competent contractor working, where appropriate, to an approved method statement					
Rev.	Date	Description	By	Chkd	App'd
P1.2	04.04.17	CLIENT COMMENTS		HM	
P1.1	30.01.17	DRAWING CREATED		HM	

Drawing Status: **FOR INFORMATION**

ATKINS

The Hub
500 Park Avenue
Aztec West
Almondsbury
Bristol
BS32 4RZ
Tel: +44 (0)1454 662000
Fax: +44 (0)1372 663333
www.atkinsglobal.com

Copyright © Atkins Limited (2014)

Client: **OXFORDSHIRE COUNTY COUNCIL**

Project Title		A44-A4260 OXFORD CORRIDOR STUDY			
Drawing Title		A4260 PROPOSED LAYOUT SHEET 3 OF 3 (OPTION 1)			
Scale	1:1000	Designed	PDE	Drawn	HM
Original Size	A1	Date	30/01/17	Date	30/01/17
Checked		Date	00/00/00	Date	00/00/00
Authorised		Date		Date	
Drawing Number	A44	Originator	ATK	Volume	HGN
HA PIN	A4260	- DR - D	- 0006a	Revision	
Location		Type	Role	Number	P1.2

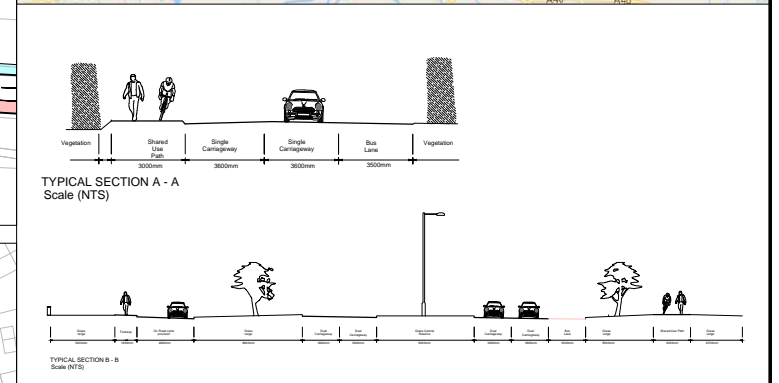
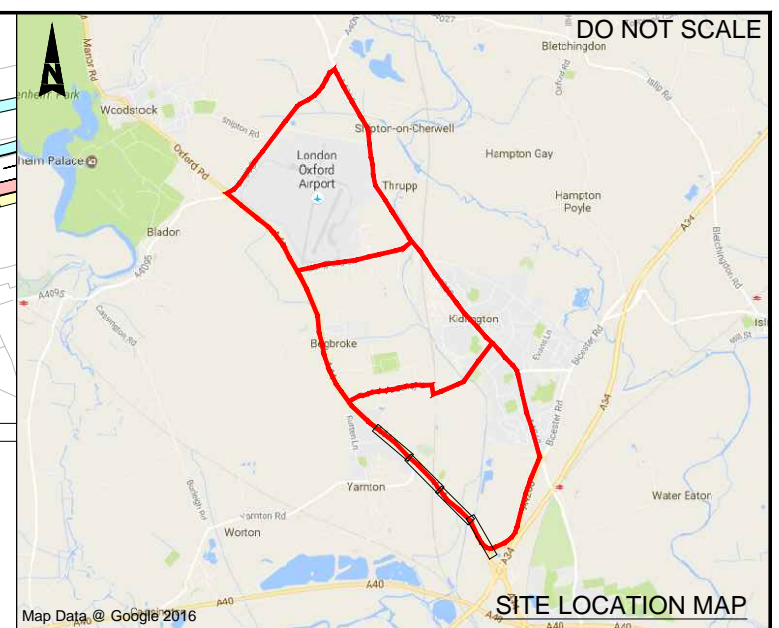
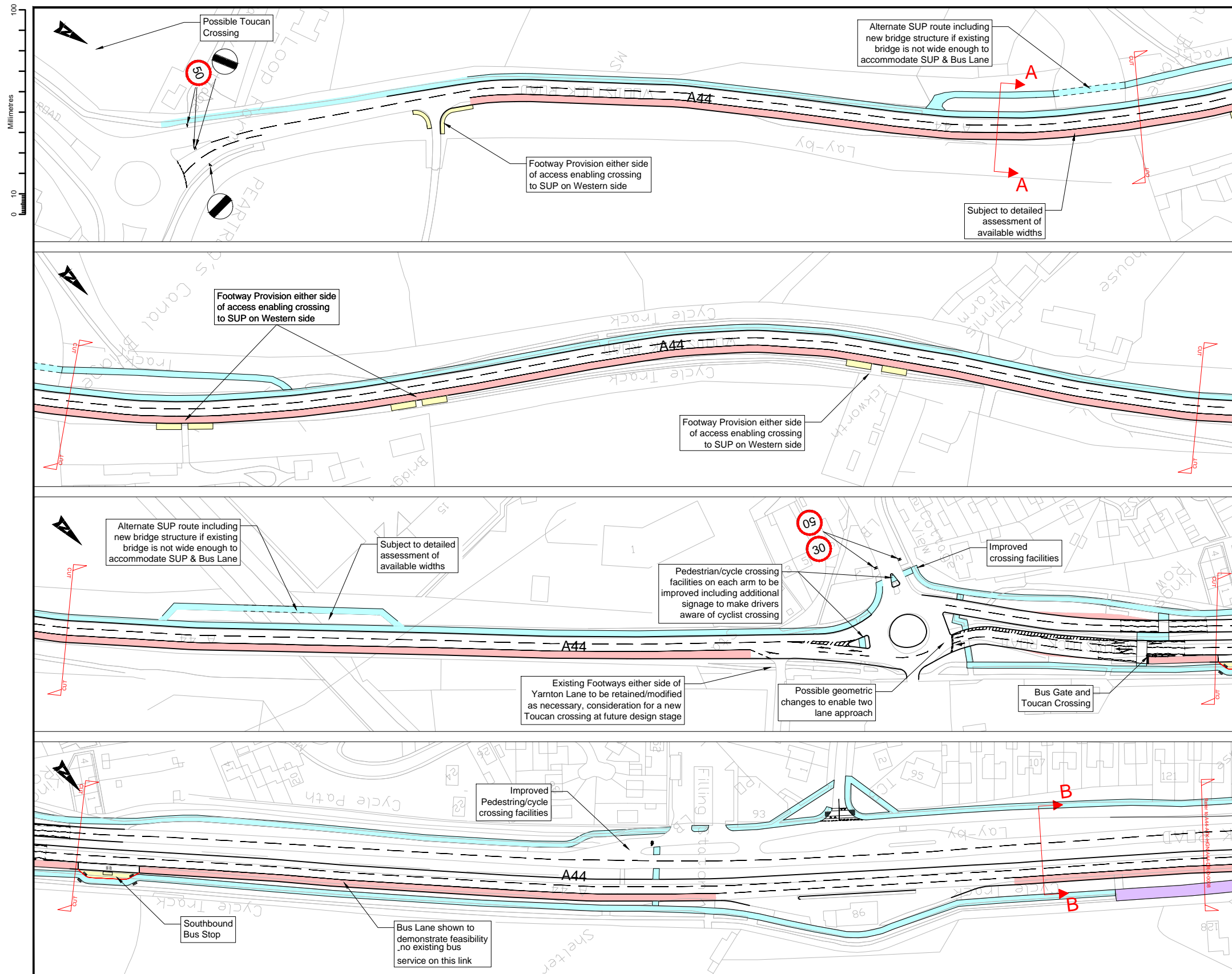

Notes

- All dimensions shown in millimeters based on OS mapping only.
- Proposals subject to confirmation of actual available widths from Topographical Survey and detail design.

Key:

- Full Height Kerbline
- Hybrid/Light Segregation
- Mandatory Cycle Lane
- Advisory Cycle Lane
- On-Street Parking
- Bus Lane
- Footway
- Shared Use Path (Segregated)
- Cycle Lane Hatching (Only Shown at Potential Conflict Points)
- On road cycle provision incorporating possible speed control measures

SAFETY, HEALTH AND ENVIRONMENTAL INFORMATION			
In addition to the hazards/risks normally associated with the types of work detailed on this drawing, note the following:			
CONSTRUCTION			
NONE			
MAINTENANCE/CLEANING			
NONE			
DECOMMISSIONING/DEMOLITION			
NONE			
It is assumed that all works will be carried out by a competent contractor working, where appropriate, to an approved method statement			

<p>FOR INFORMATION</p> <p>ATKINS</p> <p>The Hub 500 Park Avenue Aztec West Almondsbury Bristol BS32 4RZ Tel: +44 (0)1454 662000 Fax: +44 (0)1372 663333 www.atkinsglobal.com</p> <p>Copyright © Atkins Limited (2014)</p>	<p>Drawing Status</p> <p>SO</p>	<p>Project Title</p> <p>A44-A4260 OXFORD CORRIDOR STUDY</p>																																								
	<p>Client</p> <p>OXFORDSHIRE COUNTY COUNCIL</p>	<p>Drawing Title</p> <p>A44 PROPOSED LAYOUT SHEET 1 OF 6</p>	<table border="1"> <tr> <th>Scale</th> <th>Designed</th> <th>Drawn</th> <th>Checked</th> <th>Authorised</th> </tr> <tr> <td>1:1000</td> <td>PDE</td> <td>HM</td> <td></td> <td></td> </tr> <tr> <th>Original Size</th> <th>Date</th> <th>Date</th> <th>Date</th> <th>Date</th> </tr> <tr> <td>A1</td> <td>25/01/17</td> <td>25/01/17</td> <td>00/00/00</td> <td>00/00/00</td> </tr> <tr> <th>Drawing Number</th> <th>Originator</th> <th>Volume</th> <th colspan="2">Project Ref. No.</th> </tr> <tr> <td>A44</td> <td>ATK</td> <td>HGN</td> <td colspan="2">5154309</td> </tr> <tr> <th>Location</th> <th>Type</th> <th>Role</th> <th>Number</th> <th>Revision</th> </tr> <tr> <td>A44</td> <td>- DR - D</td> <td>-</td> <td>0007</td> <td>P1.4</td> </tr> </table>	Scale	Designed	Drawn	Checked	Authorised	1:1000	PDE	HM			Original Size	Date	Date	Date	Date	A1	25/01/17	25/01/17	00/00/00	00/00/00	Drawing Number	Originator	Volume	Project Ref. No.		A44	ATK	HGN	5154309		Location	Type	Role	Number	Revision	A44	- DR - D	-	0007
Scale	Designed	Drawn	Checked	Authorised																																						
1:1000	PDE	HM																																								
Original Size	Date	Date	Date	Date																																						
A1	25/01/17	25/01/17	00/00/00	00/00/00																																						
Drawing Number	Originator	Volume	Project Ref. No.																																							
A44	ATK	HGN	5154309																																							
Location	Type	Role	Number	Revision																																						
A44	- DR - D	-	0007	P1.4																																						

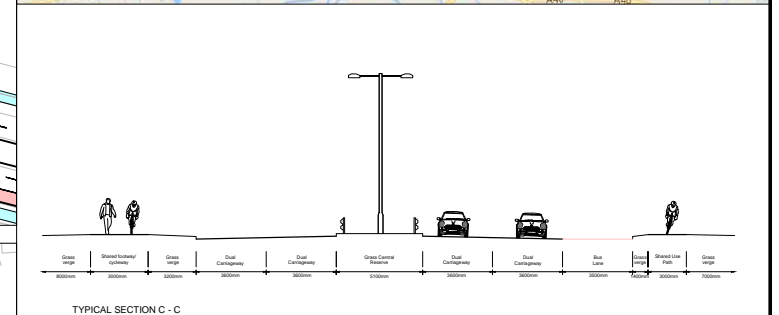
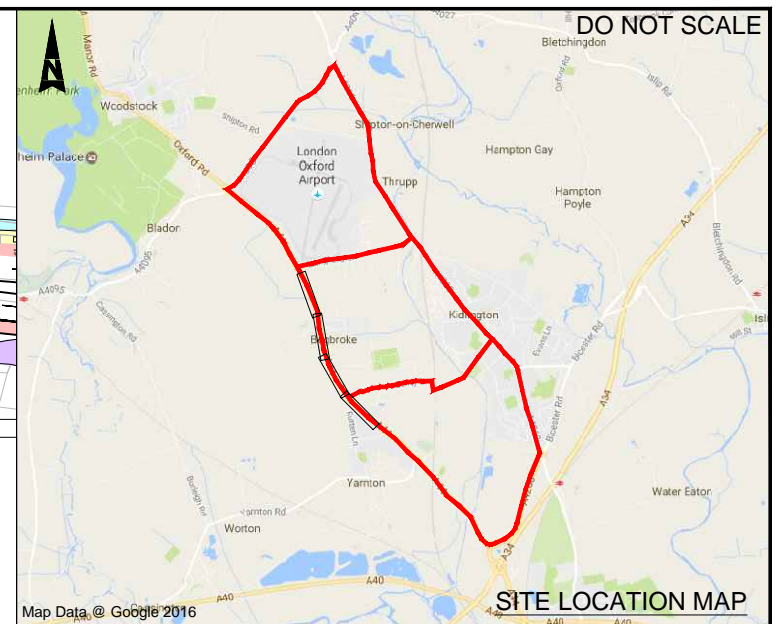
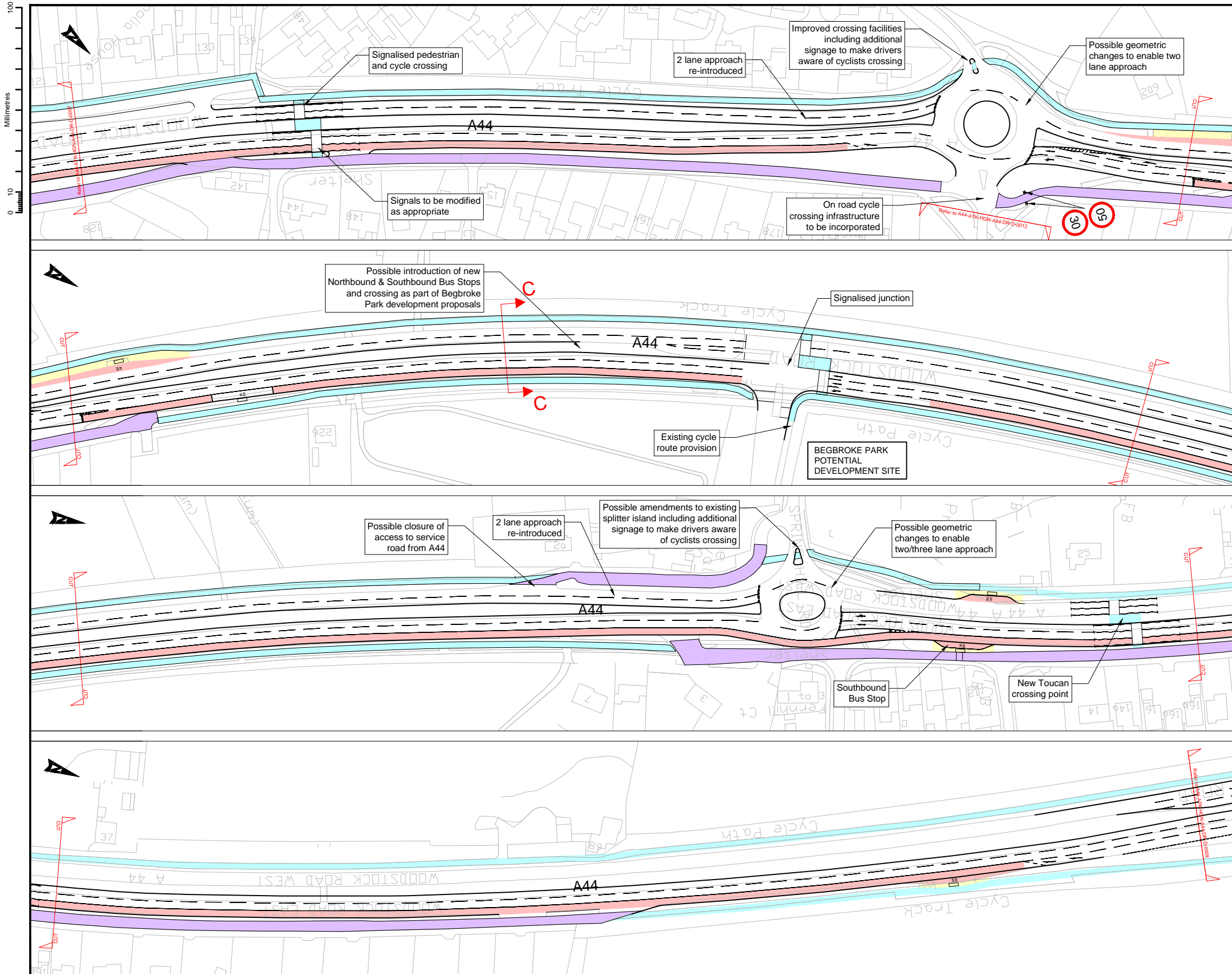

- Notes
- All dimensions shown in millimeters based on OS mapping only.
 - Proposals subject to confirmation of actual available widths from Topographical Survey and detail design.

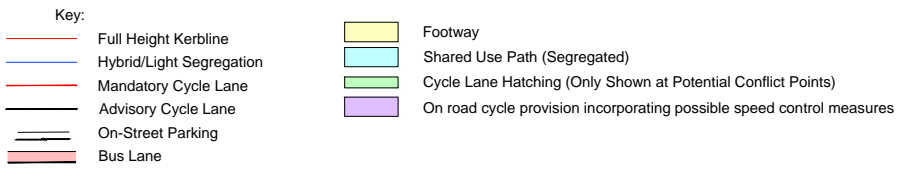

SAFETY, HEALTH AND ENVIRONMENTAL INFORMATION			
In addition to the hazards/risks normally associated with the types of work detailed on this drawing, note the following:			
CONSTRUCTION NONE			
MAINTENANCE/CLEANING NONE			
DECOMMISSIONING/DEMOLITION NONE			
It is assumed that all works will be carried out by a competent contractor working, where appropriate, to an approved method statement			

Drawing Status: **FOR INFORMATION**

ATKINS

The Hub
500 Park Avenue
Almondsbury
Bristol
BS32 4RZ
Tel: +44 (0)1454 662000
Fax: +44 (0)1372 663333
www.atkinsglobal.com

Copyright © Atkins Limited (2014)

Client: **OXFORDSHIRE COUNTY COUNCIL**

Project Title	A44-A4260 OXFORD CORRIDOR STUDY				
Drawing Title	A44 PROPOSED LAYOUT SHEET 2 OF 6				
Scale	1:1000	Designed	PDE	Drawn	HM
Original Size	A1	Date	25/01/17	Date	25/01/17
Checked		Date	00/00/00	Date	00/00/00
Authorised		Date		Date	
HA PIN	A44	Originator	ATK	Volume	HGN
Location	A44	Type	- DR - D	Number	- 0008
Project Ref. No.	5154309				
Revision	P1.3				

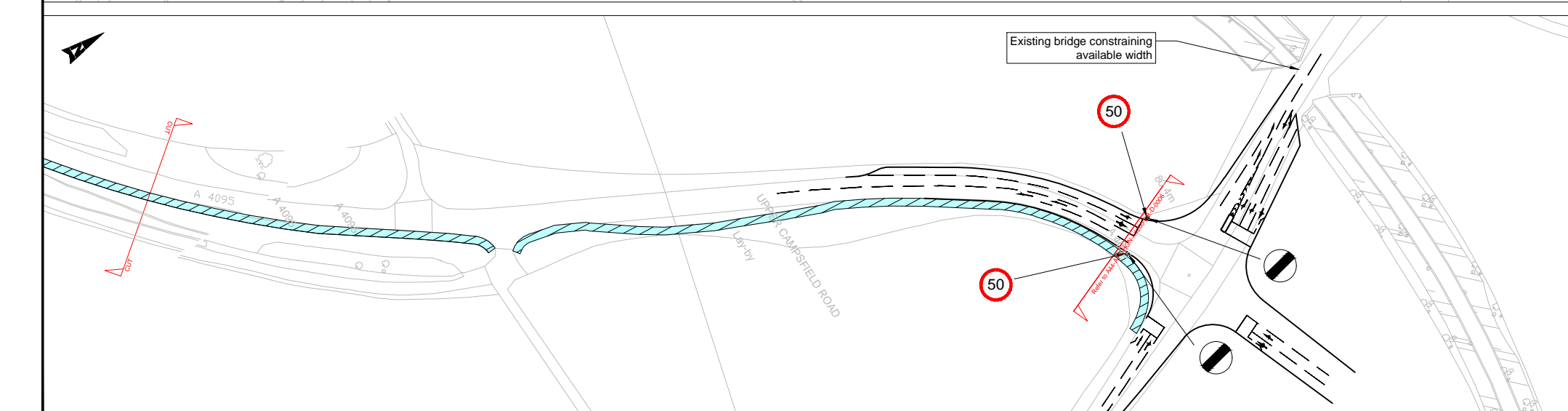
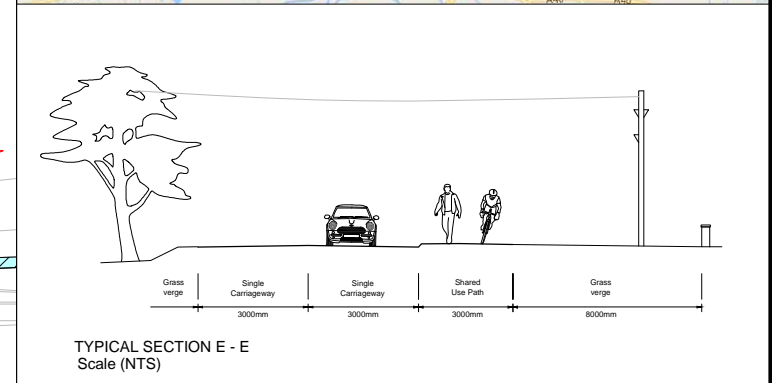
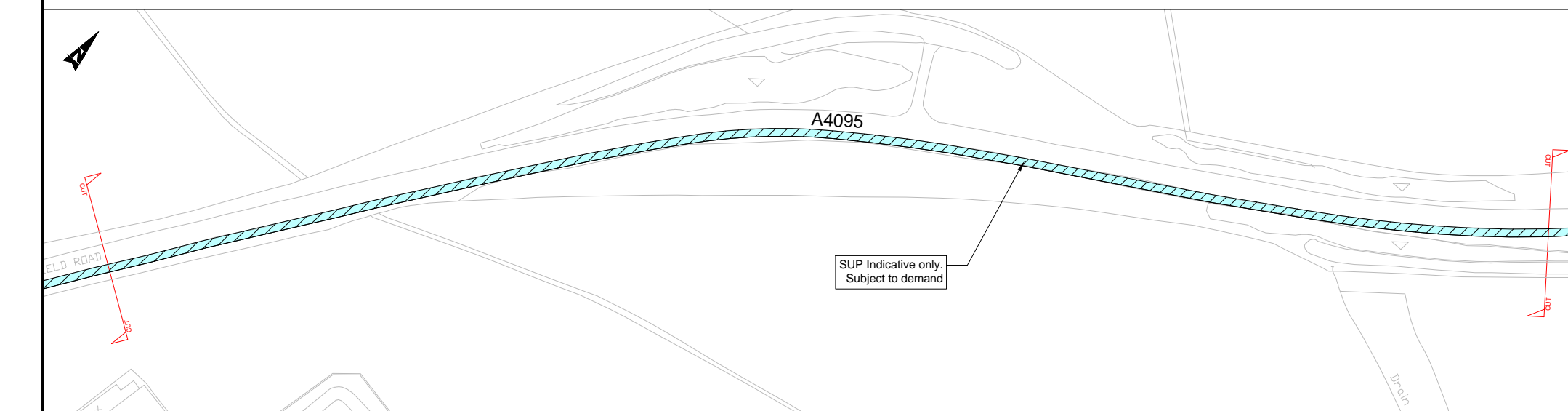
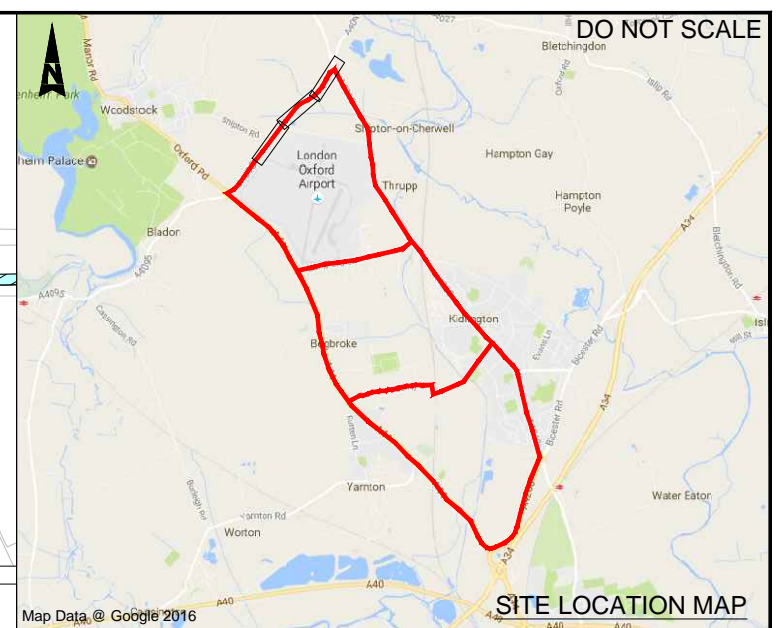
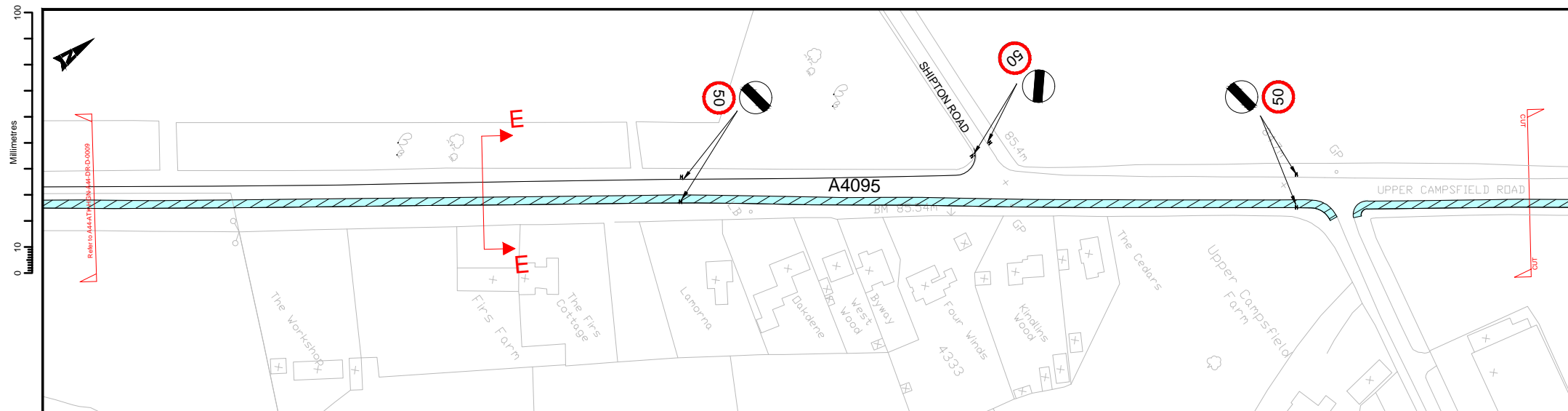

- Notes
- All dimensions shown in millimeters based on OS mapping only.
 - Proposals subject to confirmation of actual available widths from Topographical Survey and detail design.

Key:	
	Full Height Kerbline
	Hybrid/Light Segregation
	Mandatory Cycle Lane
	Advisory Cycle Lane
	On-Street Parking
	Bus Lane
	Footway
	Shared Use Path (Segregated)
	Cycle Lane Hatching (Only Shown at Potential Conflict Points)
	On road cycle provision incorporating possible speed control measures
	Potential Shared Use Path, subject to future demand

SAFETY, HEALTH AND ENVIRONMENTAL INFORMATION					
In addition to the hazards/risks normally associated with the types of work detailed on this drawing, note the following:					
CONSTRUCTION					
NONE					
MAINTENANCE/CLEANING					
NONE					
DECOMMISSIONING/DEMOLITION					
NONE					
It is assumed that all works will be carried out by a competent contractor working, where appropriate, to an approved method statement					
Rev.	Date	Description	By	Chkd	App'd
P1.3	04.04.17	CLIENT COMMENTS		HM	
P1.2	17.02.17	CLIENT COMMENTS		HM	
P1.1	25.01.17	DRAWING CREATED		HM	

Drawing Status: **FOR INFORMATION**

ATKINS

The Hub
500 Park Avenue
Aztec West
Almondsbury
Bristol
BS32 4RZ
Tel: +44 (0)1454 662000
Fax: +44 (0)1372 663333
www.atkinsglobal.com

Copyright © Atkins Limited (2014)

Client: **OXFORDSHIRE COUNTY COUNCIL**

Project Title		A44-A4260 OXFORD CORRIDOR STUDY			
Drawing Title		A44 PROPOSED LAYOUT SHEET 4 OF 6			
Scale	1:1000	Designed	PDE	Drawn	HM
Original Size	A1	Date	25/01/17	Date	25/01/17
Checked		Date	00/00/00	Date	00/00/00
Authorised		Date		Date	
HA PIN	A44	Originator	ATK	Volume	HGN
Location	A44	Type	- DR - D	Role	- 0010
Project Ref. No.	5154309		Revision	P1.3	

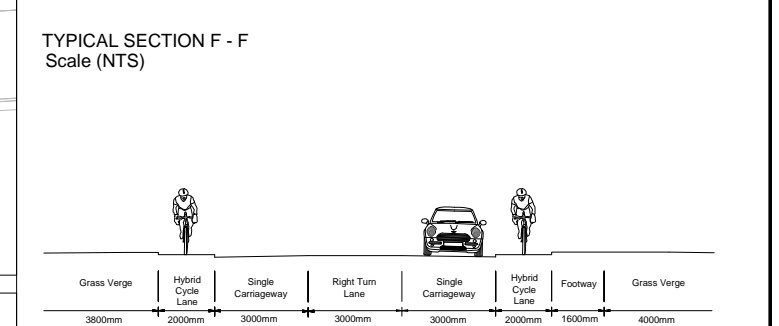
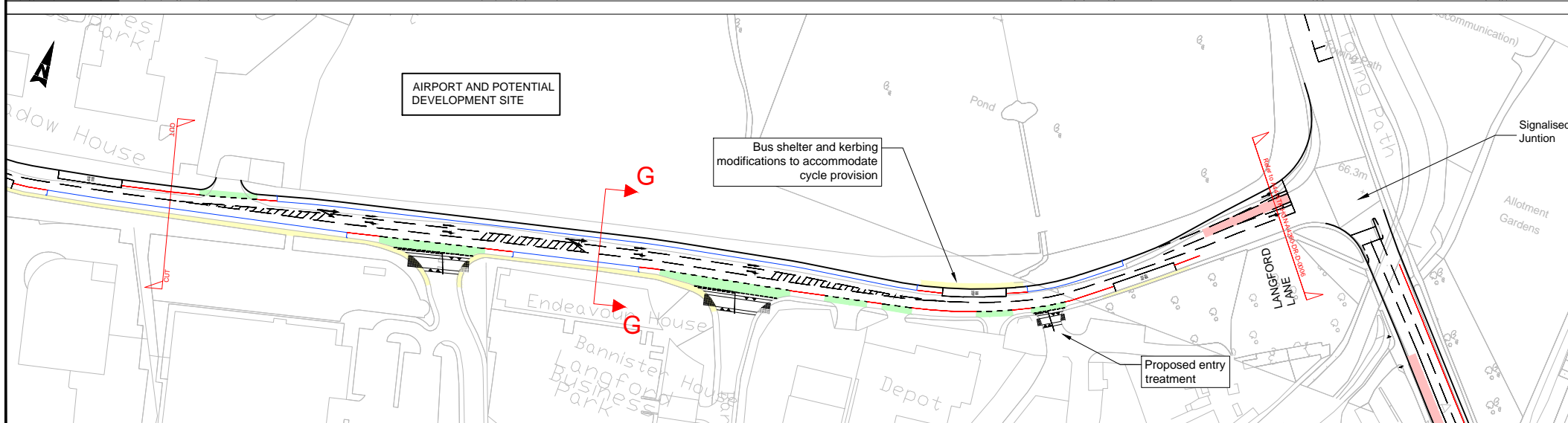
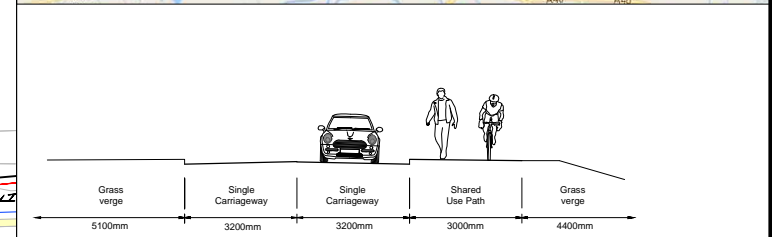
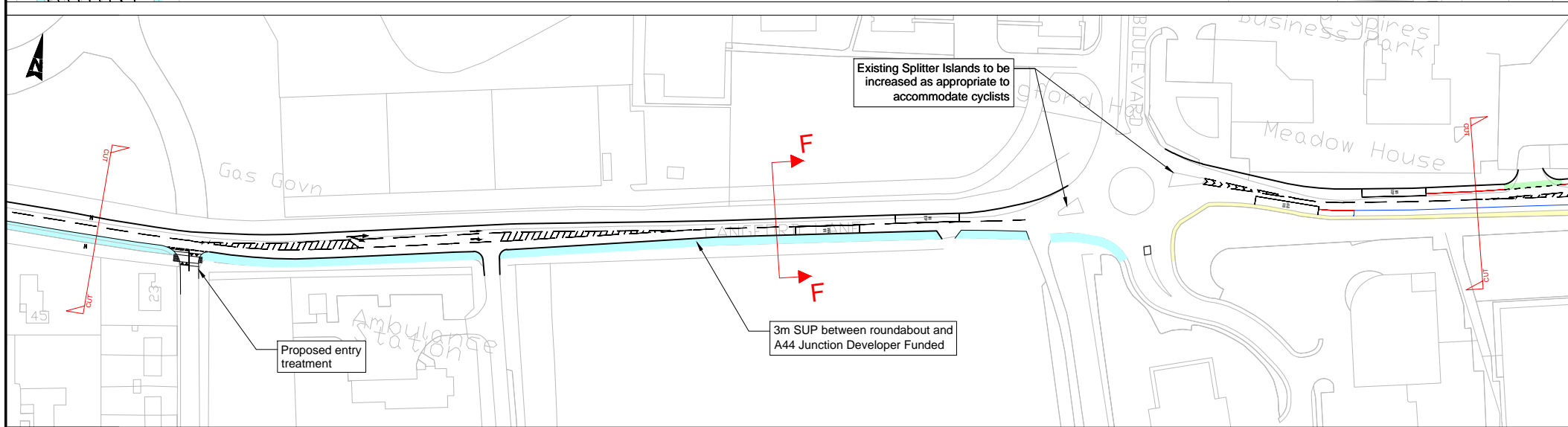
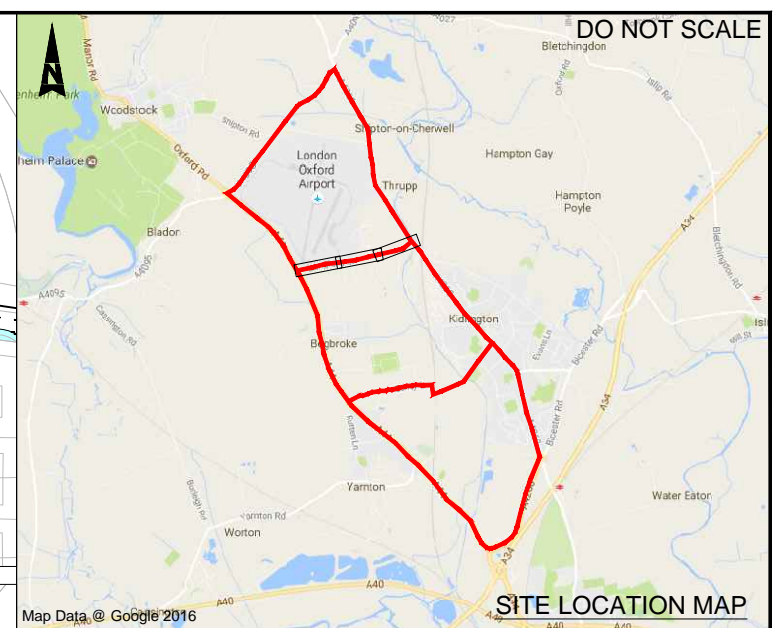
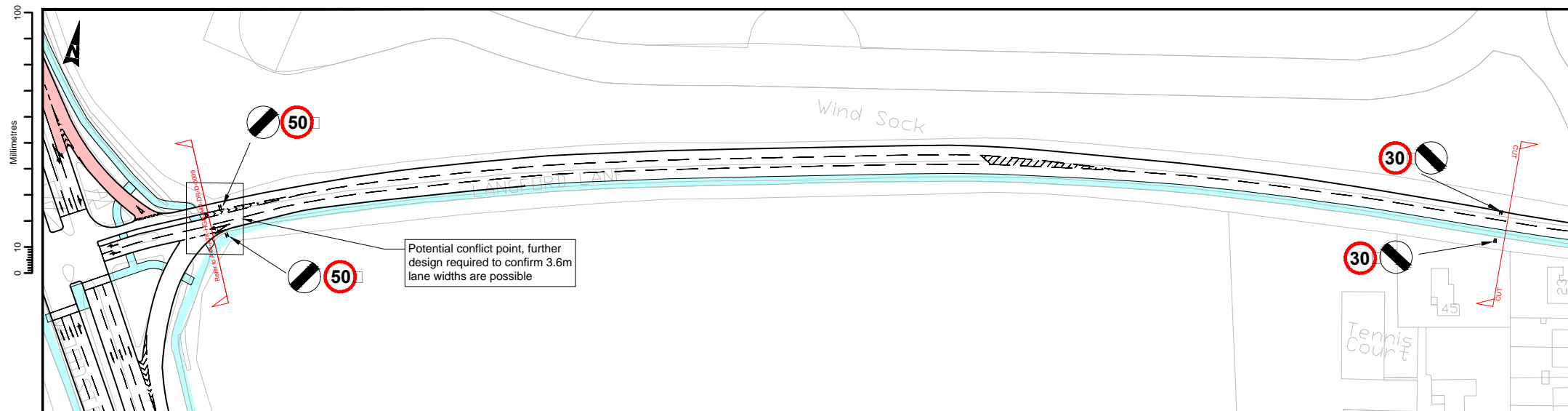

- Notes
- All dimensions shown in millimeters based on OS mapping only.
 - Proposals subject to confirmation of actual available widths from Topographical Survey and detail design.
- Key:
- Full Height Kerbline
 - Hybrid/Light Segregation
 - Mandatory Cycle Lane
 - Advisory Cycle Lane
 - On-Street Parking
 - Bus Lane
 - Footway
 - Shared Use Path (Segregated)
 - Cycle Lane Hatching (Only Shown at Potential Conflict Points)
 - On road cycle provision incorporating possible speed control measures

SAFETY, HEALTH AND ENVIRONMENTAL INFORMATION					
In addition to the hazards/risks normally associated with the types of work detailed on this drawing, note the following:					
CONSTRUCTION					
NONE					
MAINTENANCE/CLEANING					
NONE					
DECOMMISSIONING/DEMOLITION					
NONE					
It is assumed that all works will be carried out by a competent contractor working, where appropriate, to an approved method statement					
Rev.	Date	Description	By	Chkd	App'd
P1.3	04.04.17	CLIENT COMMENTS		HM	
P1.2	17.02.17	CLIENT COMMENTS		HM	
P1.1	25.01.17	DRAWING CREATED		HM	

Drawing Status: FOR INFORMATION

ATKINS

The Hub
500 Park Avenue
Aztec West
Almondsbury
Bristol
BS32 4RZ
Tel: +44 (0)1454 662000
Fax: +44 (0)1372 663333
www.atkinsglobal.com

Copyright © Atkins Limited (2014)

Client: OXFORDSHIRE COUNTY COUNCIL

Suitability: SO	Project Title: A44-A4260 OXFORD CORRIDOR STUDY			
Drawing Title: A44 PROPOSED LAYOUT SHEET 5 OF 6				
Scale: 1:1000	Designed: PDE	Drawn: HM	Checked:	Authorised:
Original Size: A1	Date: 25/01/17	Date: 25/01/17	Date: 00/00/00	Date: 00/00/00
Drawing Number: A44	Originator: ATK	Volume: HGN	Project Ref. No: 5154309	
Location: A44	Type: -DR - D	Role: - 0011	Revision: P1.3	

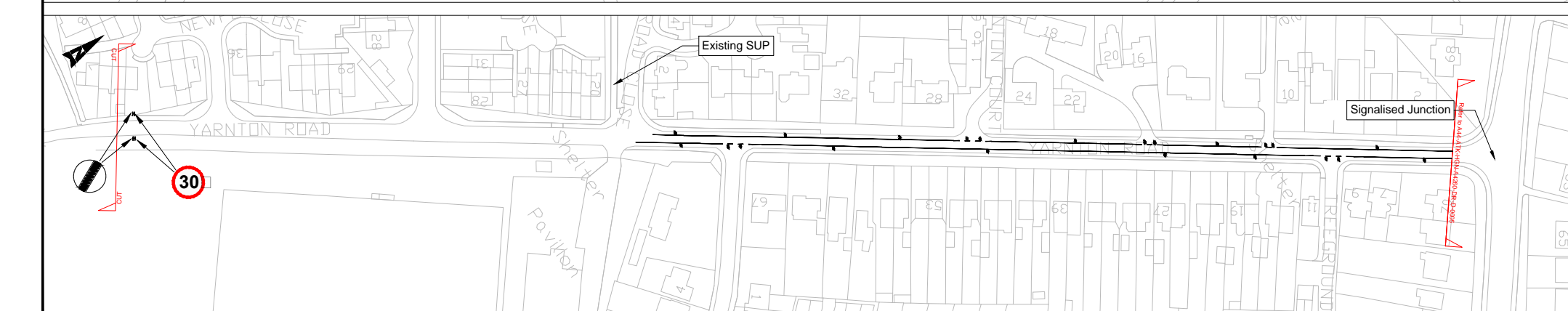
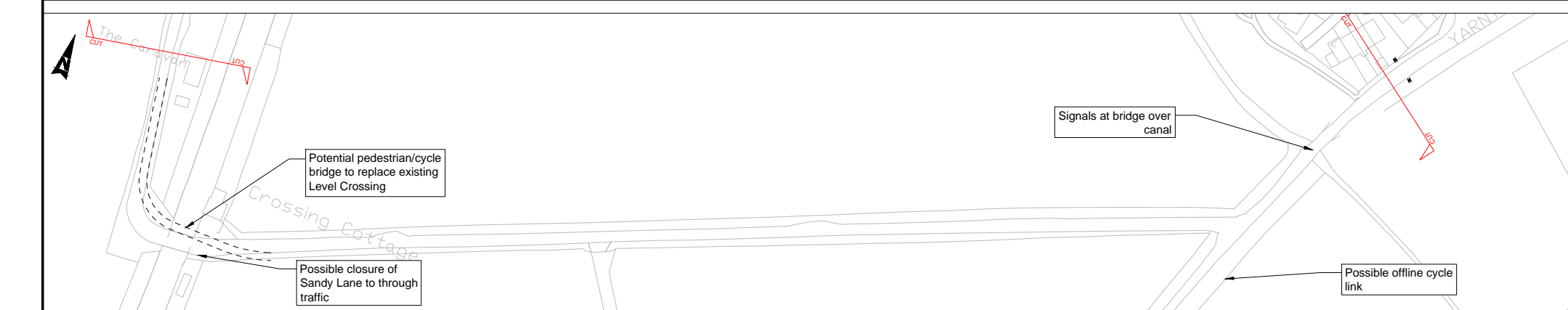
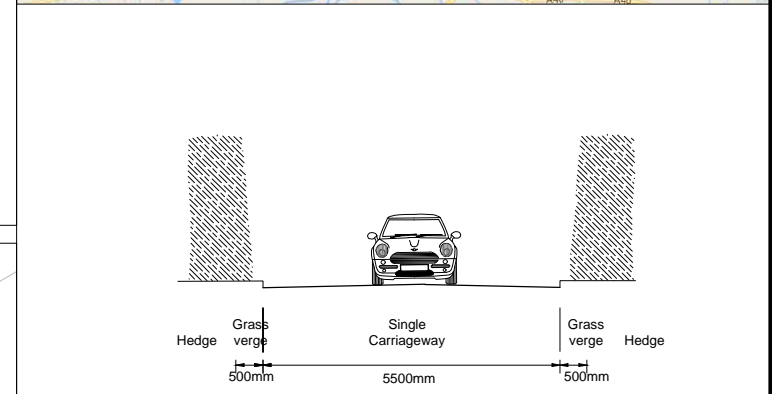
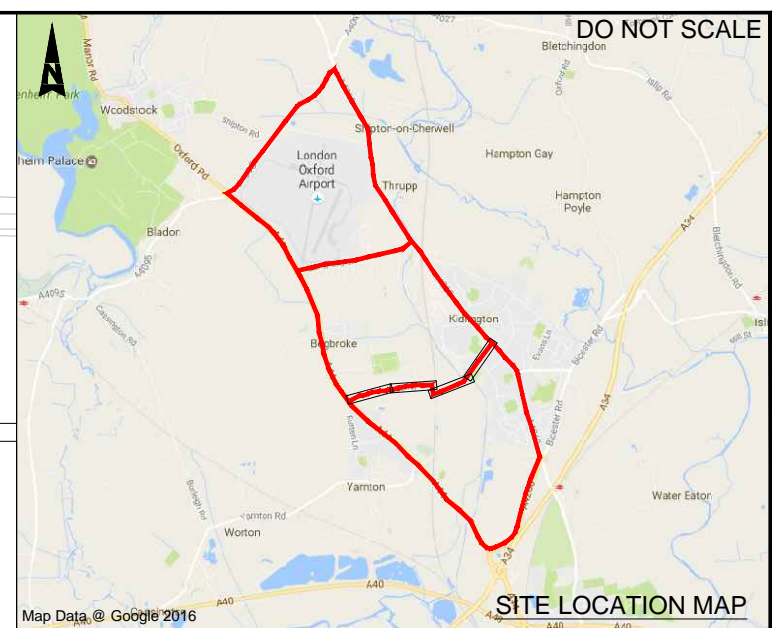
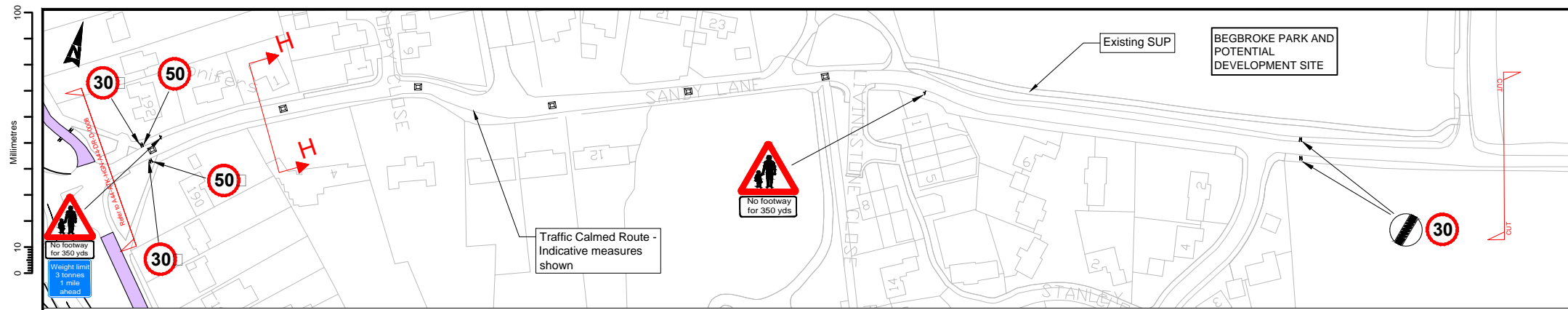

- Notes
- All dimensions shown in millimeters based on OS mapping only.
 - Proposals subject to confirmation of actual available widths from Topographical Survey and detail design.

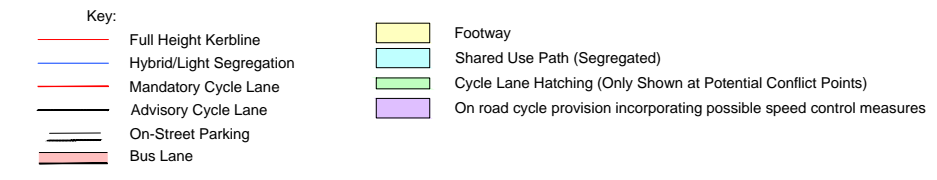

SAFETY, HEALTH AND ENVIRONMENTAL INFORMATION					
In addition to the hazards/risks normally associated with the types of work detailed on this drawing, note the following:					
CONSTRUCTION NONE					
MAINTENANCE/CLEANING NONE					
DECOMMISSIONING/DEMOLITION NONE					
It is assumed that all works will be carried out by a competent contractor working, where appropriate, to an approved method statement					
Rev.	Date	Description	By	Chkd	App'd
P1.3	04.04.17	CLIENT COMMENTS			HM
P1.2	17.02.17	CLIENT COMMENTS			HM
P1.1	25.01.17	DRAWING CREATED			HM

Drawing Status: **FOR INFORMATION**

ATKINS

The Hub
500 Park Avenue
Aztec West
Almondsbury
Bristol
BS32 4RZ
Tel: +44 (0)1454 662000
Fax: +44 (0)1372 663333
www.atkinsglobal.com

Copyright © Atkins Limited (2014)

Client: **OXFORDSHIRE COUNTY COUNCIL**

Project Title		A44-A4260 OXFORD CORRIDOR STUDY			
Drawing Title		A44 PROPOSED LAYOUT SHEET 6 OF 6			
Scale	Designed	Drawn	Checked	Authorised	
1:1000	PDE	HM			
Original Size	Date	Date	Date	Date	
A1	25/01/17	25/01/17	00/00/00	00/00/00	
Drawing Number	Originator	Volume	Project Ref. No.		
A44	ATK	HGN	5154309		
A44	- DR - D -	- 0012	Revision		
Location	Type	Role	Number	P1.3	